

VILLAGE PROPERTY



G03/22 Rothschild Avenue Rosebery NSW

Available 29th May

The 'Rothschild' Rosebery is a lifestyle-led precinct nestled on the fringe of Australia's most vibrant capital city. Rosebery is rich with European influences and in close proximity to the CBD, Eastern beaches, Sydney Airport, and other local transport connections including Green Square train station & bus to City every 10 mins.

Woolworth's just a two minute walk, fantastic cafes, sport ground facilities and parklands are within walk from your new home. With Waterloo's Danks Street, The Cannery and Alexandria minutes away, The Rothschild is the ideal location to live, work, play and shop.

[For full version visit the website](https://www.villageproperty.com.au)

1 

Type : Studio

Price : \$795 Per Week

View : <https://www.villageproperty.com.au/lease/nsw/eastern-suburbs/rosebery/residential/studio/8699269>



Alan Wang
1300 62 44 00

<https://www.villageproperty.com.au>

Unit G03, 22 Rothschild Avenue , Rosebery New South Wales

Studio 1 Bath

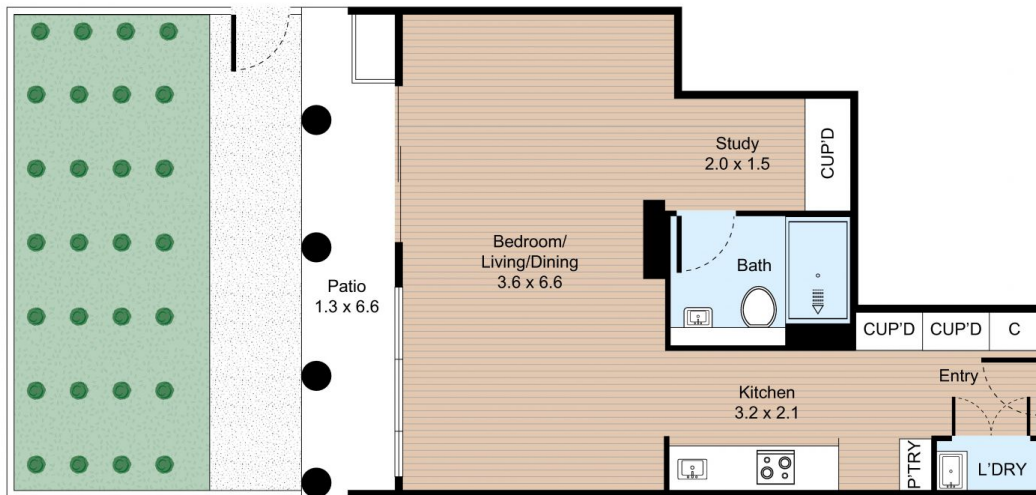

Internal : 44m²
External : 9m²



FLOOR PLAN

VILLAGE PROPERTY

All information contained herein is gathered by Little Hinges. Whilst the scanning technology is highly reliable, we cannot guarantee its accuracy and interested parties should rely on their own enquiries.