

VILLAGE PROPERTY



803/197-199 Castlereagh Street Sydney NSW

1 1 1

In the ultimate lifestyle location and immersed in lush green views over Hyde Park, this sophisticated apartment is ideally situated in the sought-after Victoria Tower building, and on the doorstep of the Sydney's business, dining and entertainment precinct. Stylish in its design and generous in its layout, it offers a superb inner-city retreat with light-filled interiors, a super-sized entertainment terrace and a user-friendly floorplan that takes full advantage of the outlooks. This exceptional CBD location is within a stroll to all the attractions that make Sydney so popular, with restaurants, Hyde Park, the QVB and train stations all within easy reach of the front door.

- A bright north-east aspect and energetic cityscape surrounds

Type : Apartment

Price : Price guide \$850,000

View : <https://www.villageproperty.com.au/sale/nsw/sydney-city/sydney/residential/apartment/8627078>



Nick Barnett
1300 62 44 00

[For full version visit the website](https://www.villageproperty.com.au)

<https://www.villageproperty.com.au>

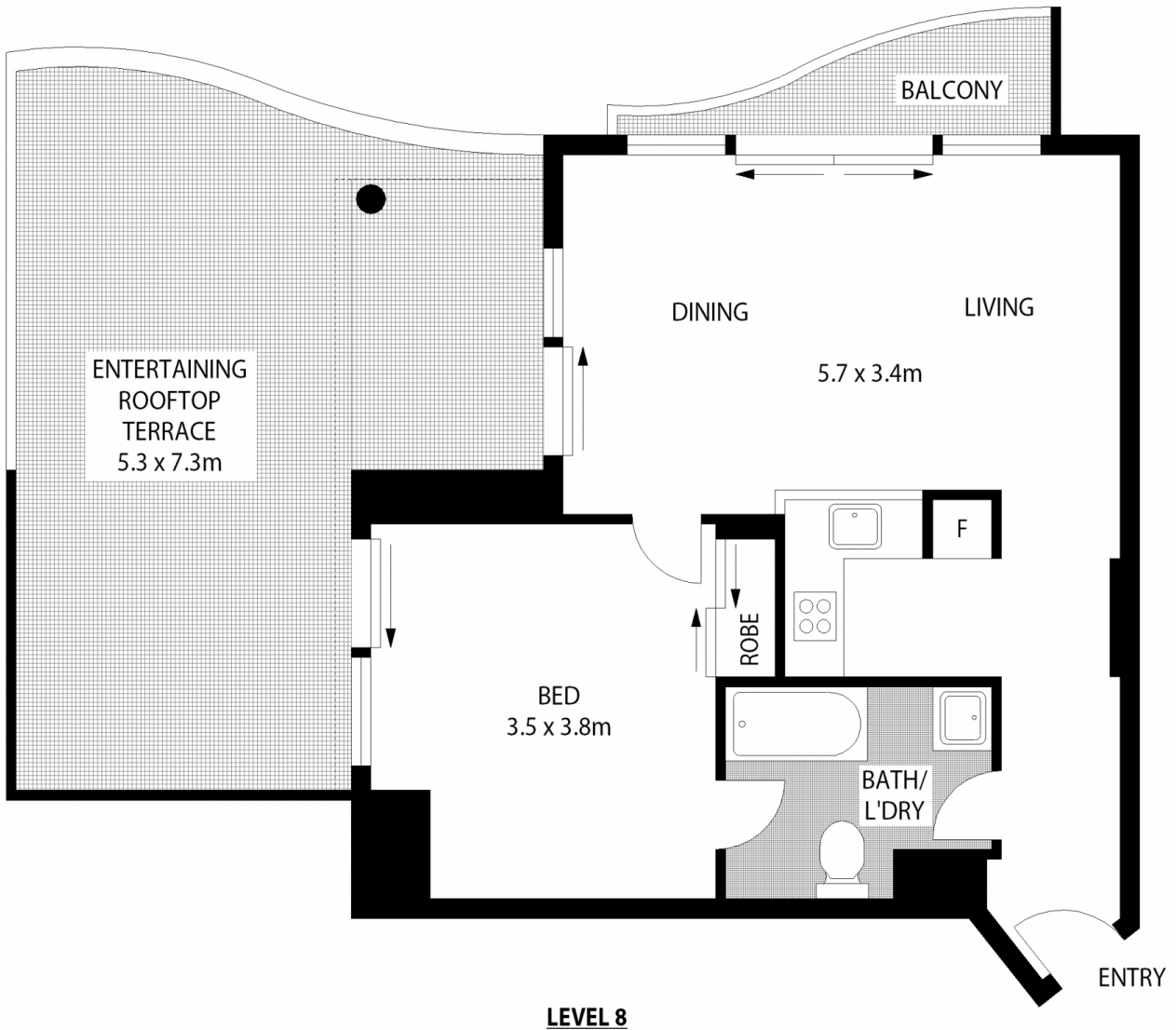

LEVEL 8

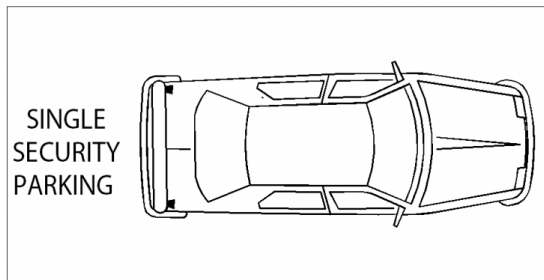

803/197-199 CASTLEREAGH STREET

SYDNEY

SCAPE Floor Planning Disclaimer: This floor plan is conceptual only. It is provided for illustrative purposes only and should not be relied upon. We make no guarantee as to the correctness of this plan. All interested parties should make and rely on their own enquiries in determining the accuracy of the information contained in this floor plan.