

VILLAGE PROPERTY



1003/7-9 Gibbons Street Redfern NSW

2 🛏 2 🚿 1 🚗

Available 17th September -

The Urba development, a contemporary streamlined design providing luxurious apartment living. This apartment is a perfect balance of aesthetics and practicality, warmth and clean minimalism; complemented by sleek and stylish finishes with a bright open living area. When it comes to convenience and lifestyle, you can't go past this central city-fringe location within walking distance to the train station, Sydney Uni, local cafes and wine bars. Only minutes train ride to the CBD and bus routes options for ease of travel.

Lease periods minimum 12 months.

[For full version visit the website](https://www.villageproperty.com.au)

Type : Apartment
Price : DEPOSIT TAKEN
View : <https://www.villageproperty.com.au/lease/nsw/ea-stern-suburbs/redfern/residential/apartment/8454271>



Alan Wang
1300 62 44 00

UNITS 15, 24, 33, 42, 51, 60,
69, 78, 87, 96, 105, 114, 123

Internal area: 78m²
External area: 16m²
Total area: 94m²

Key Plan

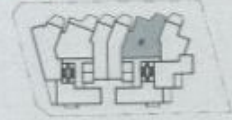

APT _____
PRICE _____
LEVEL _____



The document was produced prior to commencement of construction. None of the information contained in this document should be relied on as if constituted an advice, a recommendation or an offer for the sale of property. The developer, its agents and related entities do not make any representation or give any warranty that the information set out in this document is or will remain accurate or complete at all times and they disclaim all liability for errors, omissions, or omissions which appear in connection with any use or reliance on the information. The plans of the apartments and buildings are indicative only. Changes may be made during the development and any dimensions, fixtures and specifications are subject to change without notice.

7-8 Gibbons St. Redfern
www.urbaredfern.com.au

8569 8500 **CBRE**
CB RICHARD ELLIS

