

# VILLAGE PROPERTY



**205/39-47 Mentmore Avenue Rosebery NSW**

1 1

Available NOW

This unique development incorporates modern architecture with raw industrial aesthetic design to offer contemporary living. The proximity of the apartments to the Eastern Suburbs' vast attractions is what makes this such a desirable home. Easy drive to beaches, CBD, variety of shopping hubs and a host of recreational attractions.

Lease periods are 6-12 months.

Features:

- North facing with plenty sunlights
- Spacious bedroom with built in wardrobes
- Modern kitchen with gas cooking, oven, dishwasher

**Type** : Apartment

**Price** : \$700 Per Week

**View** : <https://www.villageproperty.com.au/lease/nsw/eastern-suburbs/rosebery/residential/apartment/8201100>



**Zhuoqun (kate) Zhang**  
1300 62 44 00

[For full version visit the website](https://www.villageproperty.com.au)

<https://www.villageproperty.com.au>

# Unit 205, 39-47 Mentmore Avenue, Rosebery

1 Bed 1 Bath

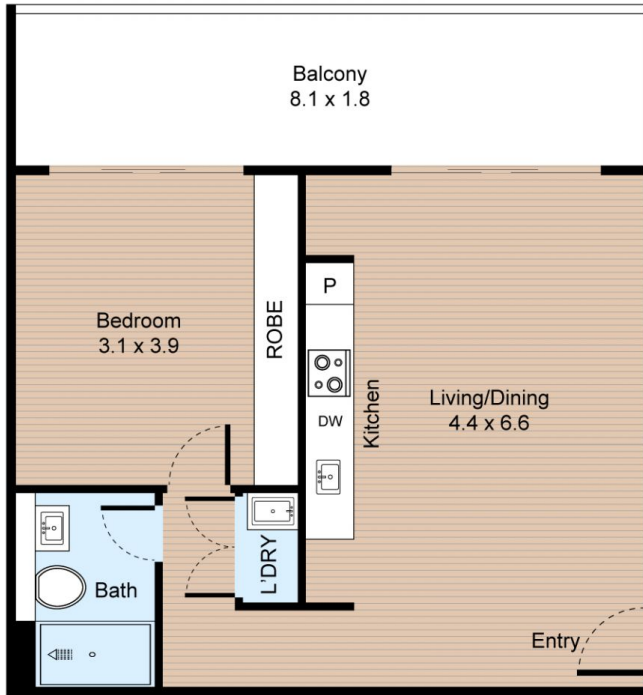

Internal : 55m<sup>2</sup>  
External : 15m<sup>2</sup>

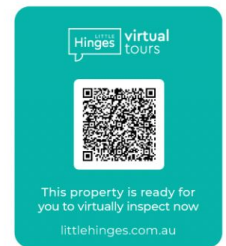

FLOOR PLAN

## VILLAGE PROPERTY

All information contained herein is gathered by Little Hinges. Whilst the scanning technology is highly reliable, we cannot guarantee its accuracy and interested parties should rely on their own enquiries.