

# VILLAGE PROPERTY

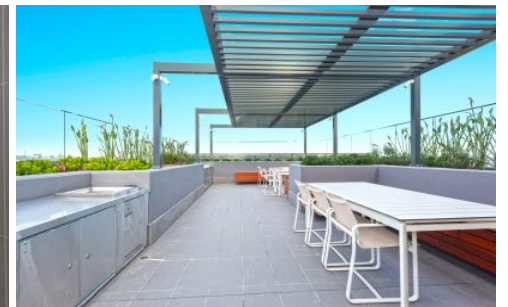

613/8 Wharf Road Gladesville NSW

1  1  1 

Available November 16th

"Wharf Square" sits proudly at the crest of Victoria Rd, Gladesville and sets the pace for executive style residences in one of Sydney's most livable areas. Ideally located close to transport, retail hubs, cafes, restaurants and local amenities including schools and park lands.

- Bedroom with built in wardrobes
  - Designer bathroom with high end marble finishes
  - Spacious balcony with exceptional water views
  - Chic kitchen with gas cooking, European appliances and marble bench-tops
- Internal laundry
- Reverse cycle, ducted air-conditioning

[For full version visit the website](https://www.villageproperty.com.au)

**Type** : Apartment  
**Price** : \$650 Per Week  
**View** : <https://www.villageproperty.com.au/lease/nsw/northern-suburbs/gladesville/residential/apartment/8167270>



**Taneisha Kerr**  
1300 62 44 00

<https://www.villageproperty.com.au>