

# VILLAGE PROPERTY



801/241 Oxford Street Bondi Junction NSW

2  2  1 

Meticulously designed by Kannfinch Architects and interiors by Koichi Takada Architects, this impressive two bedroom apartment offers a sanctuary of modern elegance amongst the enviable lifestyle of Bondi Junction.

Positioned on the 8th floor of the prestigious "Aqua", the apartment is seamlessly integrated with abundant natural light streaming through floor-to-ceiling sliding glass doors. The interior showcases a harmonious fusion of whitewashed timber floors, sandy tones of the Breeze scheme, and the subtle contrast of soft grey timber floors and stone hues. Every detail of Aqua is tailored for executive living, boasting a North East aspect that bathes the space in sunlight throughout the day. Whether indulging in the open living and dining area or unwinding in the

**Type** : Apartment

**Price** : SOLD X JACK WILLIAMS & GENE KINGSTON

**View** : <https://www.villageproperty.com.au/sale/nsw/eastern-suburbs/bondi-junction/residential/apartment/8009416>



**Gene Kingston**  
1300 62 44 00



**Jack Williams**  
1300 62 44 00

[For full version visit the website](https://www.villageproperty.com.au)

<https://www.villageproperty.com.au>

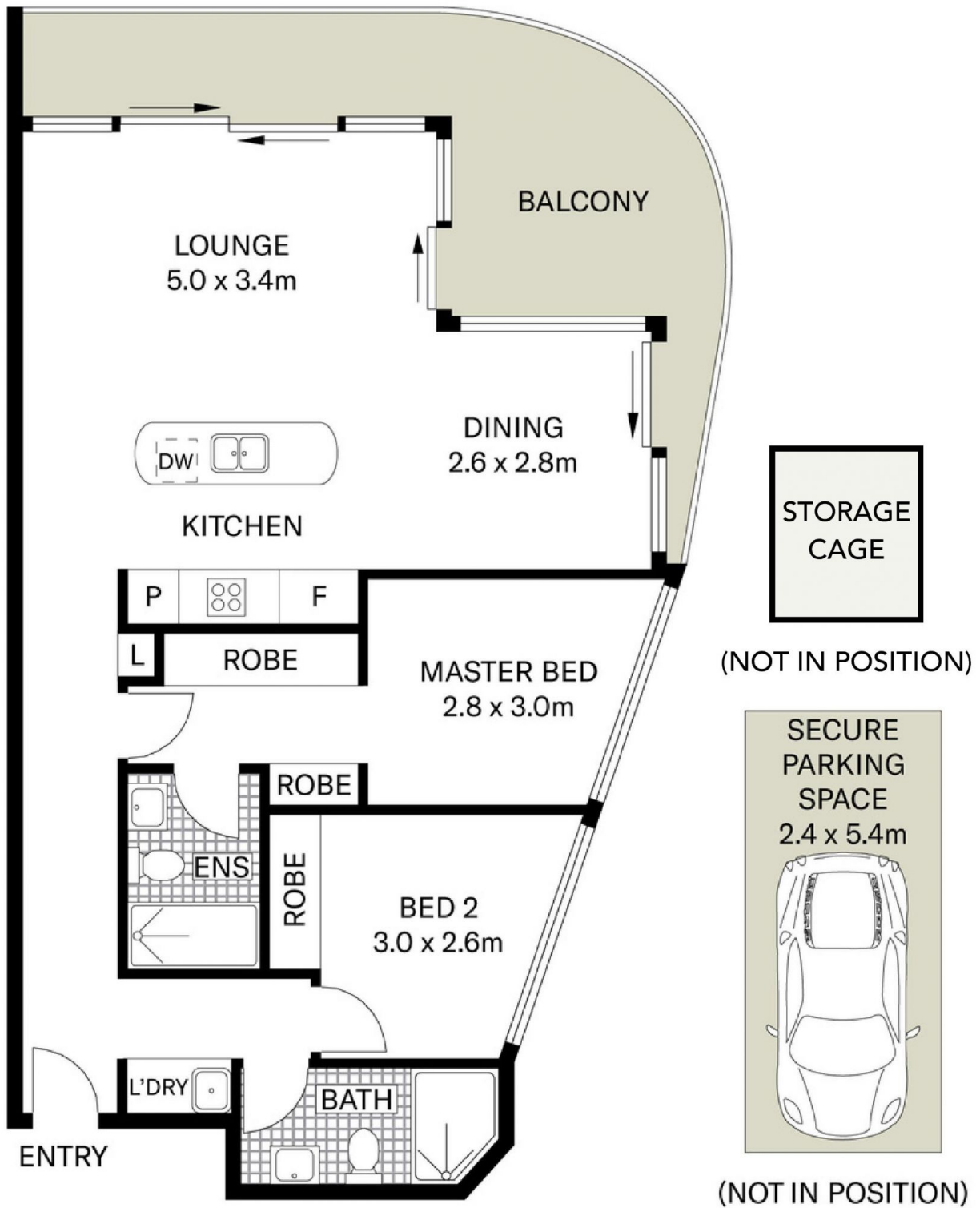

All information contained herein is gathered from sources we believe to be reliable. We cannot however guarantee its accuracy and parties should and rely on their own requirements.



801/241 Oxford Street, Bondi Junction

**VILLAGE**  
PROPERTY