



VILLAGE PROPERTY



216/280 Jones Street Pyrmont NSW

1  1 

Available from 6th May-

Displaying a fresh modern design, this oversized studio apartment promises a premium inner-city lifestyle with its highly convenient locale. It makes an ideal choice for those seeking a high-quality, easy-to-maintain property that is private, secure and tucked away within the sought-after Harbour Mill heritage building close to the heart of the CBD and is perfectly positioned with light rail transport at the doorstep, and a stroll to the foreshore walks around Blackwattle Bay.

- Crisp open-plan design with generous light-filled areas
- Timber floor through living area and bedroom
- Customised gas kitchen with excellent storage and Smeg

Type : Studio

Price : \$680 Per Week

View : <https://www.villageproperty.com.au/lease/nsw/sydney-city/pyrmont/residential/studio/7994252>



Zhuoqun (Kate) Zhang
1300 62 44 00

[For full version visit the website](https://www.villageproperty.com.au)

<https://www.villageproperty.com.au>

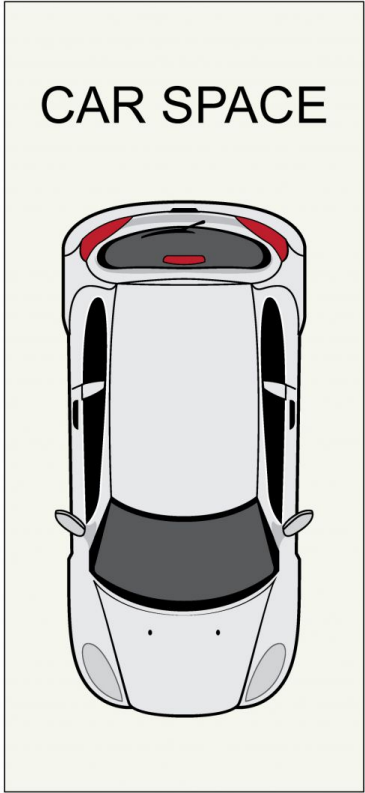
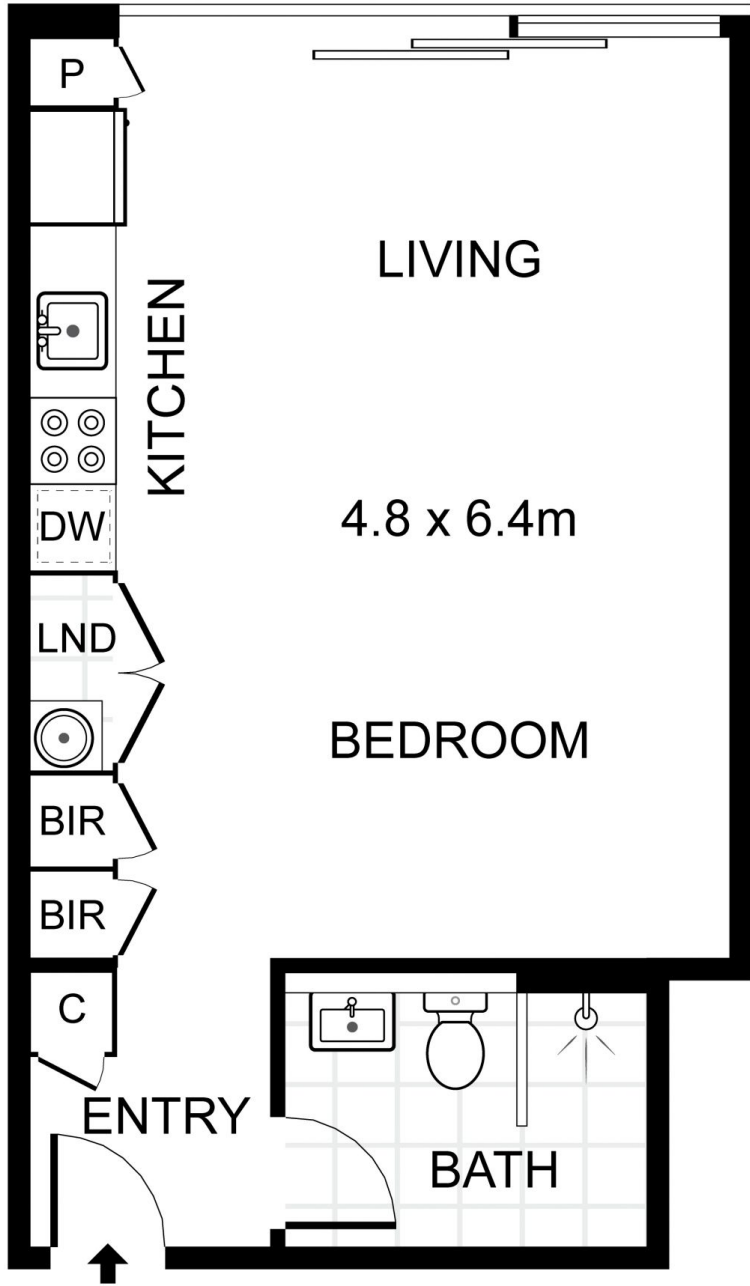

LEVEL TWO

216/280 Jones Street, Pyrmont



DISCLAIMER: PLANS SHOWN ARE FOR PRESENTATION PURPOSES AND ARE NOT PART OF ANY LEGAL DOCUMENT. ALL MEASUREMENTS AND FIGURES ARE APPROXIMATE.