

VILLAGE PROPERTY



402/23 Pelican Street Surry Hills NSW

1 🛏 1 🚿

Available 23rd April

At the top of Surry Hills resides a spectacular apartment block with stunning interior features in a convenient location. With classic, luxurious styling and generous layout for apartments so close to the CBD; the Pelican apartments are exquisitely crafted for your comfort and convenience.

Spacious living and dining, clever separation between open areas and sleeping zones as well as smart storage options are built in. A stones throw from the vibrant Oxford street and surrounded by all the amenities of inner city living. Only 7 minutes walk to Museum Train Station. Enjoy the buzz of the latest bars, cafes and popular restaurants within walking distance. 400 metres from Hyde Park. Move

[For full version visit the website](https://www.villageproperty.com.au/lease/nsw/eastern-suburbs/surry-hills/residential/apartment/7971296)

Type : Apartment

Price : \$810 Per Week DEPOSIT TAKEN AFTER FIRST INSPECTION

View : <https://www.villageproperty.com.au/lease/nsw/eastern-suburbs/surry-hills/residential/apartment/7971296>



Alan Wang
1300 62 44 00

<https://www.villageproperty.com.au>

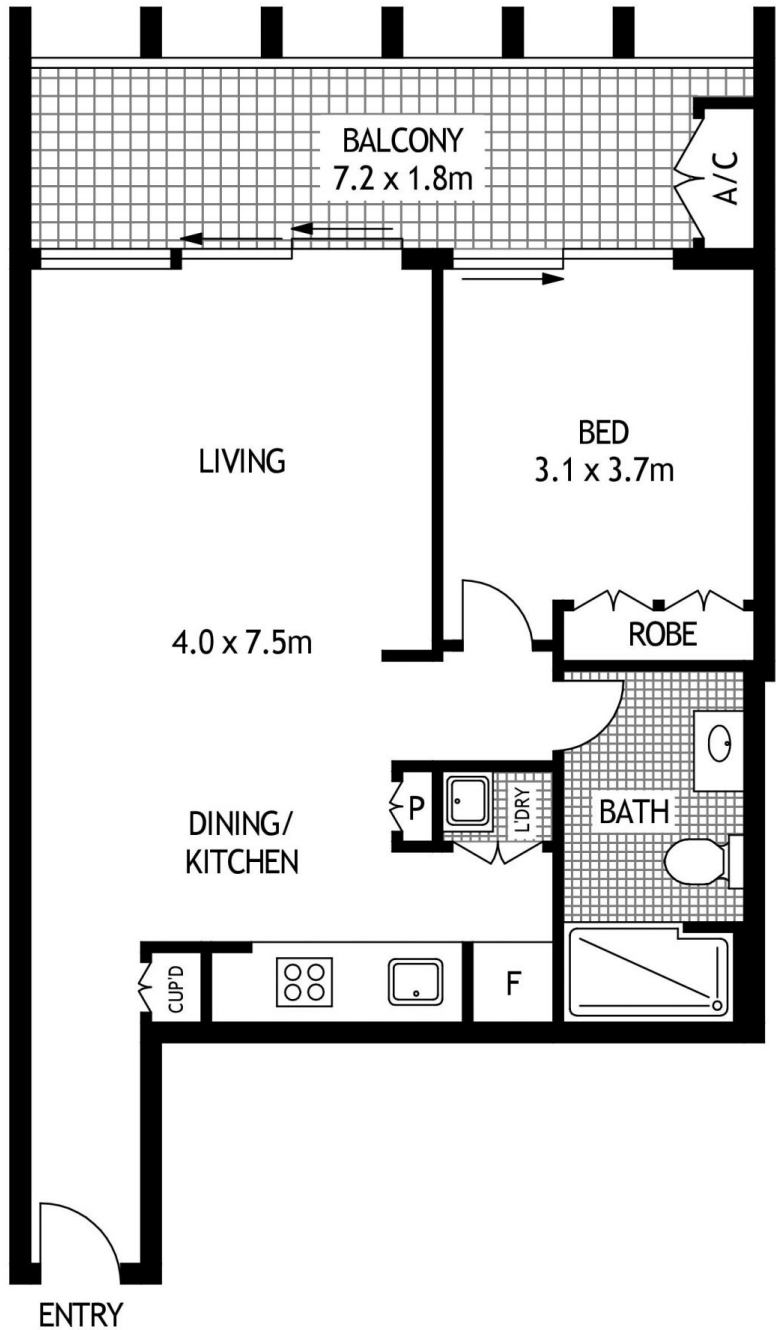

FOURTH FLOOR



402/23 PELICAN STREET

SURRY HILLS

SCAPE Floor Planing Disclaimer: This floor plan is conceptual only. it is provided for illustrative purposes only and should not be relied upon. We make no guarantees to the correctness of this plan. All interested parties should make and rely on their own enquiries in determining the accuracy of the information contained in this floor plan.