

# VILLAGE PROPERTY

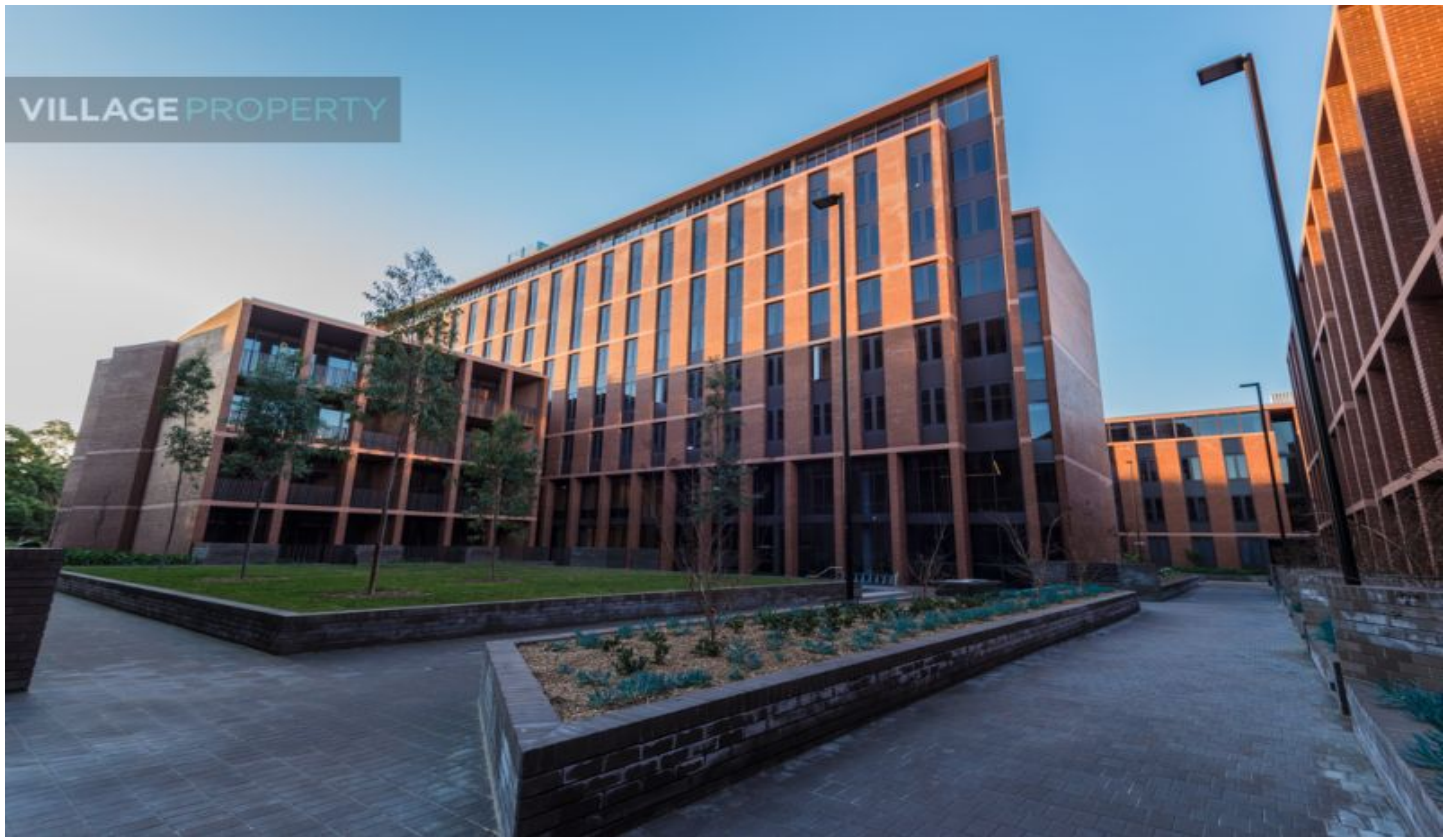

3208/6 Grove Street Dulwich Hill NSW

1 1 1

Available 24th January

This highly regarded apartment, located in the near new Arlington Grove development will meet all your needs with its smart floor plan and high quality finishes throughout. Fantastically located; one minute walk to Arlington Light Rail stop - be in Sydney's CBD in 30 minutes, moments to Johnson Park and Arlington Recreation Reserve and close to vibrant village hubs of Dulwich Hill and Marrickville. You are just a Moments stroll to Johnson Park and Arlington Recreation Reserve and the iconic Sideways Deli Cafe. Located in the inner city hubs of Dulwich Hill and Marrickville, Arlington Grove is at the heart of a new approach to urban style.

[For full version visit the website](https://www.villageproperty.com.au/lease/nsw/inner-west/dulwich-hill/residential/apartment/7865329)

**Type** : Apartment

**Price** : \$700 Per Week DEPOSIT TAKEN

**View** : <https://www.villageproperty.com.au/lease/nsw/inner-west/dulwich-hill/residential/apartment/7865329>



**Alan Wang**  
1300 62 44 00

<https://www.villageproperty.com.au>

