

# VILLAGE PROPERTY



**A407/72 MacDonald Street Erskineville NSW**

2  2  1 

Available 20th December

Located in a highly regarded development with lush communal gardens and a shared rooftop area, this modern apartment is bathed in natural light. Eve has brought a new standard of living to the heart of Erskineville's vibrant village culture.

Ideally situated only moments from the vibrant Enmore and Newtown entertainment precinct, the lush greenery of Sydney Park and Moore Park grounds. Surrounded by abundance of cafes and restaurants, and weekend markets dotted throughout the energetic inner west. Short stroll to St Peter or Erskineville Train station and Woolworths Metro Park Sydney minutes walk away for your everyday

**Type** : Apartment

**Price** : \$900 Per Week DEPOSIT TAKEN

**View** : <https://www.villageproperty.com.au/lease/nsw/inner-west/erskineville/residential/apartment/7823054>



**Alan Wang**  
1300 62 44 00

[For full version visit the website](https://www.villageproperty.com.au)

<https://www.villageproperty.com.au>

# EVE

BY Fridcorp™

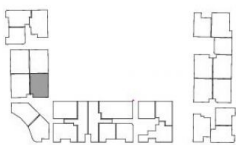

Macdonald St

## APARTMENT A407

<b>Internal</b>	72.4 m <sup>2</sup>
<b>External</b>	11.0 m <sup>2</sup>
<b>Total</b>	83.4 m <sup>2</sup>

**For more information**  
1800 221 336  
[EveByFridcorp.com.au](http://EveByFridcorp.com.au)

Disclaimer: This plan is a guide only and does not constitute an offer or contract. Please note changes may be made during the development and areas, fittings, fixtures and specifications are subject to change without notice in accordance with the terms of the contract of sale. All parties must rely on their own investigation to validate this information as it is not guaranteed. No liability will be accepted for any inaccuracy or misstatement. (B)

**Hecker  
Guthrie**



**CBRE**